

HOW DOES IT WORK? PORTABLE TOILETS

A comfortable practical and durable portable toilet.
No sewage, water or drainage connection needed.



Porta Potti



Porta Potti 565

The Porta Potti is a closed sanitation system which is compact and light weight. You can place the portable toilet pretty much anywhere. Porta Pottis are often used in folding tents, tents, camper trailers and boats. They can also come in handy during house renovations, summer or garden houses. They can be placed in any room at home and are suitable for all ages, even if you are less mobile.

The Porta Potti is a portable toilet which consists of two parts:



1 Flush-water tank



2 Waste-holding tank

1 Flush-water tank

Always a quiet yet powerful and fresh flush



The upper part is a combined flush-water tank and toilet bowl with detachable seat and cover.

The perfect flush



- 1 Fill the flush-water tank with water and the flush-water additive Aqua Rinse Plus.
- 2 Open the blade with the blade handle
- 3 Flush the toilet using the manual bellow (A) or piston (B) pump with three or four short flushes for an effective flush. An electric pump (C) will automatically flush the toilet.
- 4 A perfect flush

FAQ's

Q: What are the specifications of the Porta Potti? A: The Porta Potti comes in different models and sizes. The models are different in capacity of the waste-holding tank and flush-water tank, seating height, flushing system and level indicator. Consult www.thetford.com for more information.

Q: Can I use my normal household cleaners? A: No. Normal household cleaners may cause permanent damage to seals and other toilet components. Therefore Thetford has a wide range of specially developed toilet care products.

Q: I can't remove the waste-holding tank? A: Check if the blade is (partly) open. If the blade is stuck, first loosen the cap from the pour out spout.

Q: What do I need to know about my toilet while driving? A: To prevent leakage or water damage to your recreational vehicle or boat, do not travel with water in the toilet bowl, a flush-water tank that is more than 1/2 full nor with a waste-holding tank that is more than 3/4 full.

Q: I have a question about my Thetford Porta Potti? A: Please, contact the authorised local Service Centre or Thetford Customer Service in your country. Or visit www.thetford.com for more information.

2 Waste-holding tank

The clever replacement for a sewage system

Stopper

The stopper holds the pour out spout in position making it easier to re-attach the two tanks

Pour out spout

Gives an easy and clean way to empty the tank

Vent button

Prevents splashing when emptying

Blade

Closes the tank to keep the smell fresh

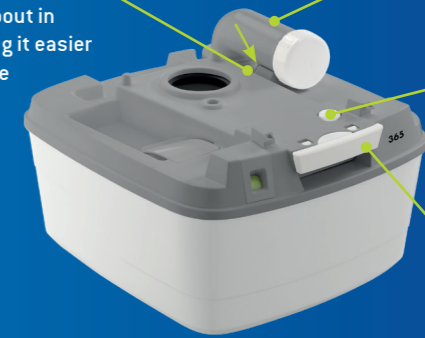

Waste-holding tank: preparing for use



- 1 Detach the two tanks with the clasp at the rear
- 2 Add 2L-3L water and the correct dosage of Aqua Kem Blue or Aqua Kem Green for perfect odour control and easier emptying

Empty the waste-holding tank



- 3 Look at the waste-holding tank level indicator (dependent on model) if the tank needs to be emptied.
- 4 Easily carry the tank to the special dump station on the campsite (and if not available a regular toilet connected to sewage infrastructure will do).
- 5 Turn the pour out spout and remove the cap.
- 6 Press and hold the vent button with your thumb while the pour out spout is pointing downwards. Empty the waste-holding tank.